

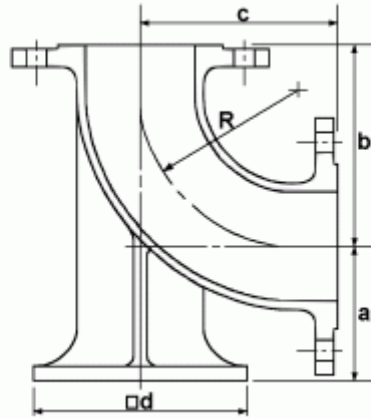

Double-Flanged 90° Duckfoot Bend



Unit: mm

Nominal size	Thickness	a	b	c	d	R	Weight (kg)
100	8.5	120	200	200	200	150	25.0
150	9.0	150	250	250	250	200	37.7

Note: 1. Working pressure: 7.5 kg/cm².

2. The dimensions of flange shall be in accordance with JIS G5527 7.5 kg/cm².